

PREVENTIVE MAINTENANCE FOR DOCK SYSTEMS

There are two main reasons to have your dock equipment regularly and properly maintained:



Improve up-time, reduce maintenance costs, extend equipment life.

Dock systems are made with components that need inspecting, cleaning, lubrication, adjustment, and possibly replacement during the equipment's normal lifecycle. Finding and fixing small problems before they become big problems is money well-spent. Dock equipment is also susceptible to damage from transport vehicles and materials handling equipment.



To comply with safety law.

Although often overlooked, there **are** OHS workplace safety requirements that apply to dock systems, and improperly functioning or configured dock equipment, especially vehicle restraint systems, can create potentially significant safety problems. Your dock equipment should always be included in your Safety Program, and be maintained to manufacturers' specifications.

Why choose us to maintain your dock equipment?

We use SafedoorPM, a PM and safety compliance program designed specifically for commercial door and dock systems, that enables us to do a better job maintaining your dock equipment. Here's how:

- ▶ **We ID and create detailed profiles of all your dock and/or door equipment.** This enables us to work smarter and more efficiently on your equipment, be proactive in addressing problem areas, and help you with equipment replacement planning.
- ▶ **The right PM work, at the right times.** Our service technicians perform and record PM work using SafedoorPM's mobile app with its expert system of manufacturers' maintenance standards and practices. This helps us ensure your dock equipment receives the right PM and service work, to the right standards, at the right times ... no more, no less.
- ▶ **Safety compliance.** SafedoorPM is specifically designed to meet *Occupational Health & Safety* standards, reduce safety liability, and fit easily into your Safety Program.
- ▶ **Transparency and detailed, no-hassle record-keeping.** Your PM records are available how you want them: hard copies, electronic files, or accessible 24/7 in the Cloud through SafedoorPM's Customer Portal.

During a SafedoorPM, we will **inspect, check, clean, lubricate, adjust, and test your dock equipment, including the dock leveler, vehicle restraint system and canopies/shelters**. All mechanical, sensory and structural elements, settings, and controls will be assessed and graded. We'll pay special attention to critical components affecting reliability and safety, and ensure all systems are functioning properly.

We'll provide you with **detailed inspection records** that clearly identify any corrective work needed to address critical safety hazards or operational problems. Any corrective service work will proceed only with your authorization. Quotations and estimates are provided.

To ensure your dock equipment remains properly maintained, we'll **recommend an ongoing PM schedule**, keep track of the PM calendar, and contact you as the next PM interval approaches.

All of your **PM records will be securely stored** on SafedoorPM's cloud-based Customer Portal, where you can access them 24/7.

WorkSafe BC

All B.C. employers have a legal responsibility for safety in their workplace.

- **Section 4.3(2)(a) Safe machinery and equipment** of the Regulations which requires all workplace equipment to be installed, inspected and maintained in accordance with the manufacturer's instructions
- **Section 4.1 Safe workplace** of the Regulations which requires the workplace to be maintained to protect people from danger
- **Workers Compensation Act, Part 3 Occupational Health and Safety, Division 3 S115(1) General duties of employers** where "Every employer must ensure the health and safety of all workers working for that employer ..."

Typical Dock System

Mechanical Dock Leveler

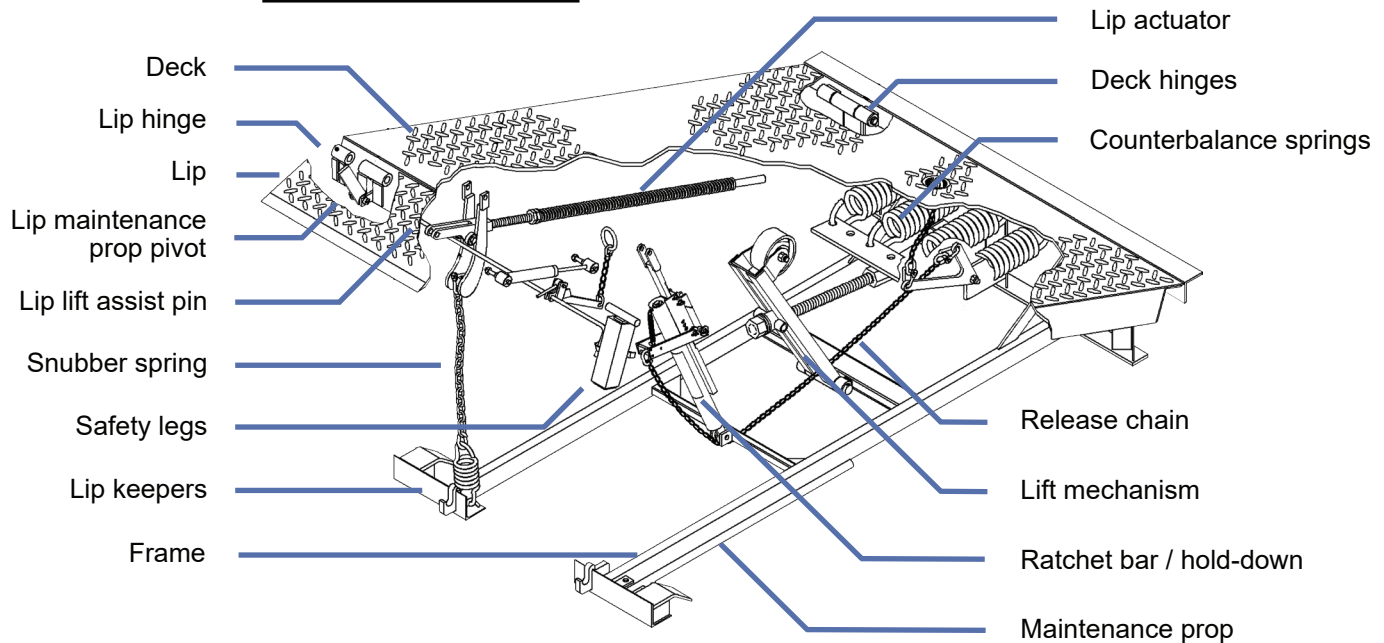

Vehicle Restraint

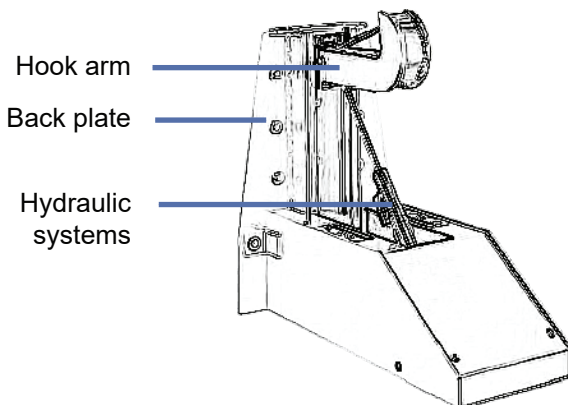

Exterior Stop / Go Light

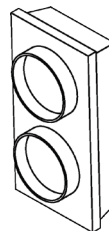

Dock Bumper

